

COMMUNITY COLLEGE OF BALTIMORE COUNTY

Essex, Maryland



Client Project

The Community College of Baltimore County (CCBC) at Essex needed alternate classroom space for 1,000 students - fast. Their Computer-Aided Drafting and Design (CADD) department building had to be closed for emergency repairs.

Client Need

School was already in session and the department was challenged with providing temporary facilities without suspending classes. The necessary space was not only large but complex; it would incorporate computer labs, specially-equipped classrooms, and administrative offices. The logical answer was modular construction because it could meet CCBC's accelerated timeline. Such a complicated project requires an experienced and resourceful modular space provider. Williams Scotsman met and surpassed those requirements.



"Williams Scotsman not only provided us with two quality buildings, they listened and responded to our concerns every step of the way."

- Terence Evelyn, Director of Plant and Facilities



800.782.1500
www.willscot.com

COMMUNITY COLLEGE OF BALTIMORE COUNTY

Essex, Maryland

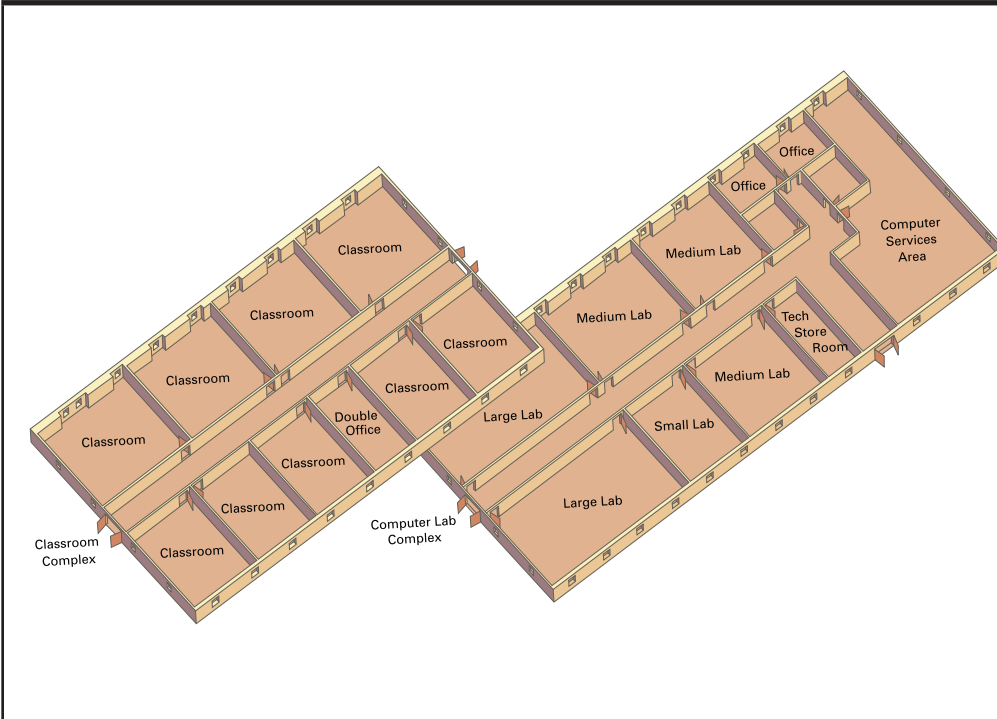

The Williams Scotsman Solution

Williams Scotsman's diligent management was committed to fast-tracking the installation process and minimizing interruptions to campus life. It provided CCBC at Essex with a turnkey installation of two buildings. Twenty-two Redi-Plex® units were utilized to house nine classrooms, six computer labs, and several administrative offices totaling 15,240 square feet. Williams Scotsman handled every detail: site preparation, installation, exterior and interior customization, permanent foundations, electrical wiring installation for the computer labs, and exterior skirting, ramps, and decks.

The Result

The Community College of Baltimore County at Essex was pleased with the temporary space and with the support they received from Williams Scotsman.

"In my line of business, I turn to people who make things happen. That takes experience and resources of a company like Williams Scotsman."

- Terence Evelyn, Director of Plant and Facilities

WILLIAMS
SCOTSMAN

ORDER RECEIVED

9/99

DELIVERY

10/99

INSTALLATION

10/99

OCCUPANCY

11/99

SPACE BY



800.782.1500

www.willscot.com